

### Peak Emission Wavelength: 1200nm

Unless otherwise specified, all drawing units are in mm  
Tolerances are: ISO 2768-m

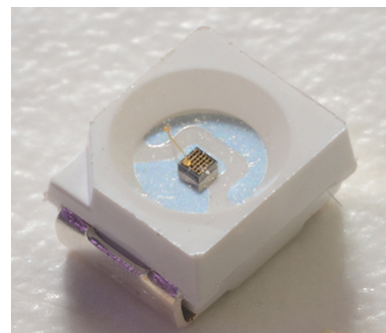
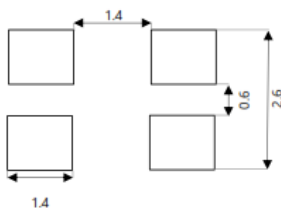
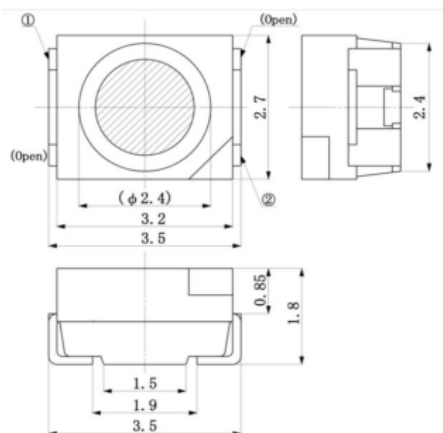

### Features:

- Color: IR, Wavelength 1200 nm Typical
- Package PLCC-4
- Package size: 3.5(L) x 2.7(W) x 1.8(H) mm
- Devices are ROHS and REACH compliant
- Lead free
- Viewing angle: 120°

Pin 1 – Cathode  
Pin 2 - Anode  
Pin 3, 4 – open

### Absolute Maximum Ratings (Ta=25°C)



| ITEMS                       | TEST CONDITIONS  | SYMBOL | RATINGS     | UNIT |
|-----------------------------|------------------|--------|-------------|------|
| Forward DC Current          |                  | If     | 50          | mA   |
| Forward Current (pulse)     | t=10us, T = 10ms | If     | 500         | mA   |
| Reverse Voltage             |                  | Vr     | 5           | V    |
| Power Dissipation           |                  | Po     | 65          | mW   |
| Operating Temperature Range |                  | Top    | -20 to +80  | °C   |
| Storage Temperature Range   |                  | Tst    | -30 to +100 | °C   |

Electrical & Optical Characteristics (Ta = 25°C)

| ITEMS              | SYMBOL                | CONDITIONS | MIN | TYP  | MAX | UNIT |
|--------------------|-----------------------|------------|-----|------|-----|------|
| Forward Voltage    | Vf                    | If=20mA    | --  | 1.0  | --  | V    |
| Radiant Power      | Po                    | If=20mA    | --  | 4.5  | --  | mW   |
| Peak Wavelength    | $\lambda_p$           | If=20mA    | --  | 1200 | --  | nm   |
| Spectral Bandwidth | $\Delta\lambda_{0.5}$ | If=20mA    | --  | 62   | --  | nm   |
| Reverse Current    | Ir                    | V=5V       | --  | --   | 10  | uA   |
| Viewing Angle      | $\Theta$              | If=20mA    | --  | 120  | --  | deg  |

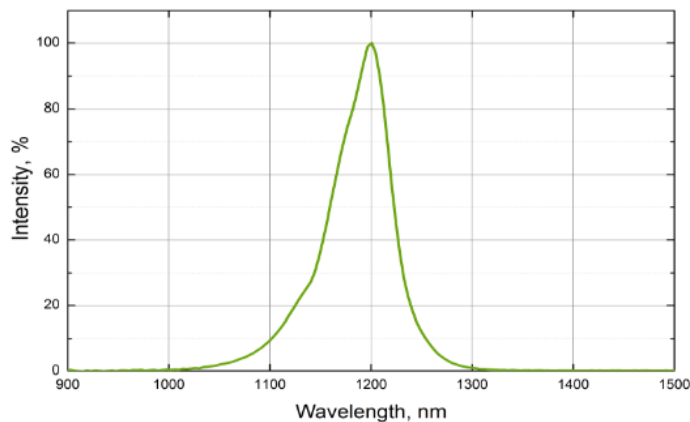

Typical spectrum @ 100 mA

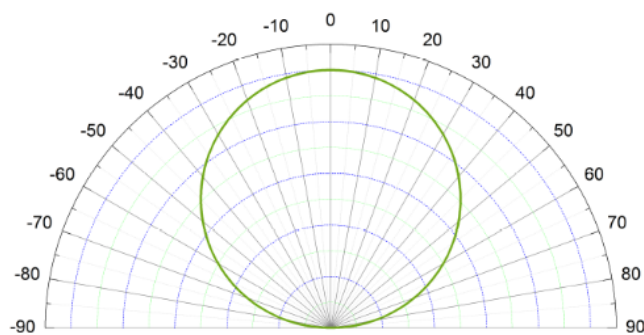

Radiation pattern

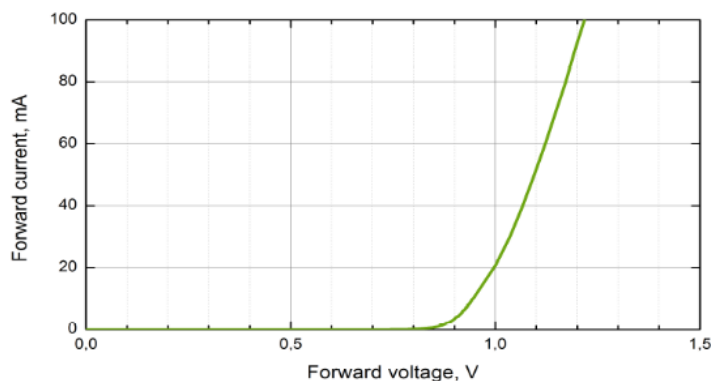

Forward current vs. forward voltage

• **Soldering Profiles**

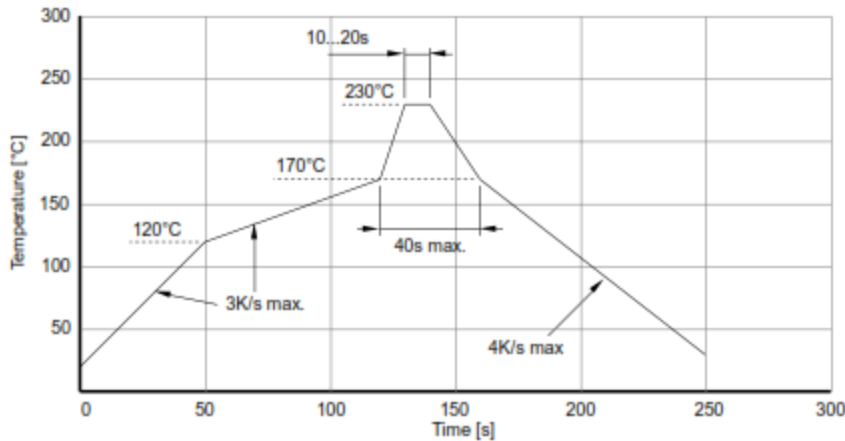

IR reflow soldering profile for solder containing Lead

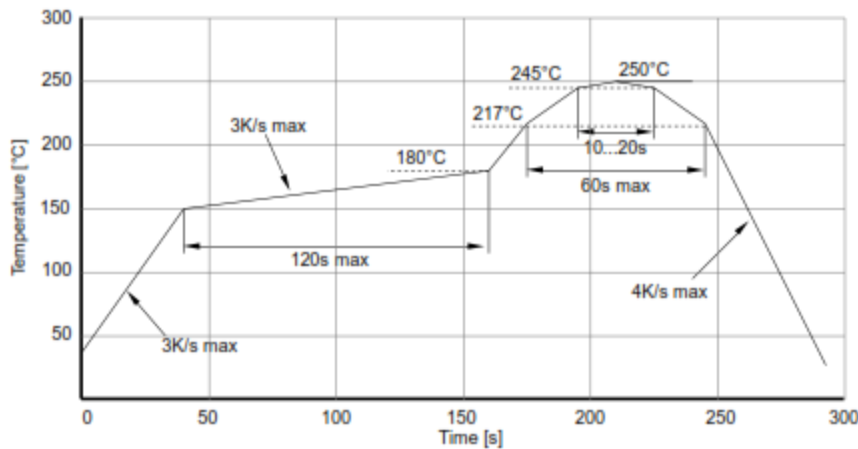

IR reflow soldering profile for Lead free soldering